

# Monteringsanvisning

## Fönsterlås Fix 2830

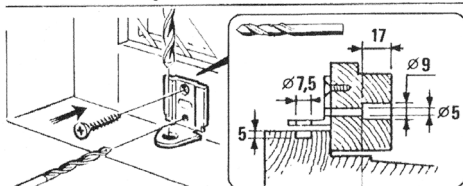

Montera med genomgående M5-skrivar.  
Kan även monteras med träskruv 4,0x40.

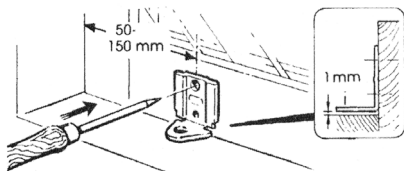
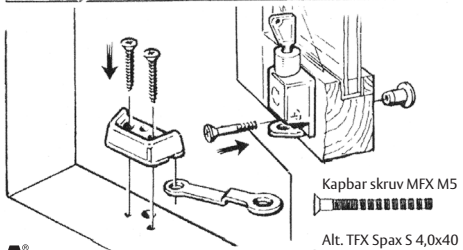
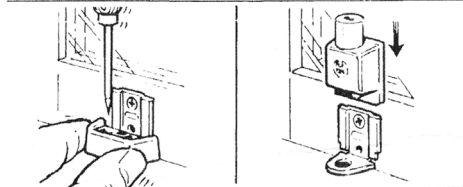

Kapbar skruv MFX M5



Alt. TFX Spax S 4,0x40



OBS! Lossa skruven försiktigt.  
Vrid ej cylinder i förhållande  
till tappen när skruven är lös.

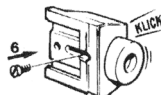
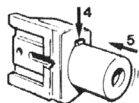
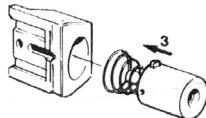
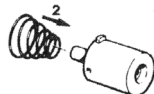
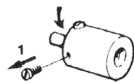

**ASSA**<sup>®</sup>  
ASSA ABLOY

ASSA OEM AB, Bruksgatan 17, 414 51 Göteborg  
Tel. 031 - 704 40 00, info.fix@assaom.se, www.assaom.se

KT 864

# Fitting instructions

## Window lock Fix 2830

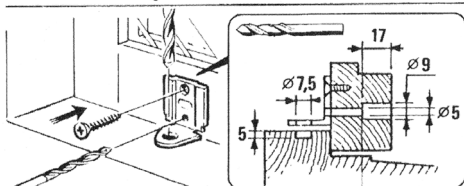
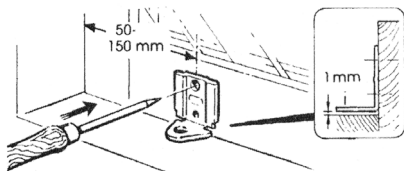

Fit with M5 screws that go through. Wood screws, 4,0x40, can also be used.

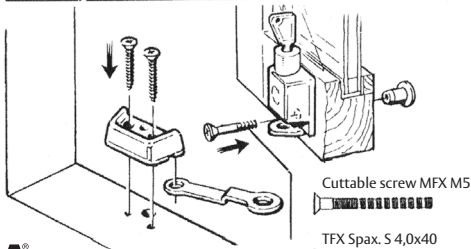
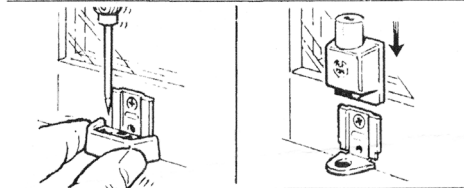

Cuttable screw MFX M5

TFX Spax. S 4,0x40

N.B. Loose the screw carefully. The cylinder should not be turned in relation to the pin when the screw is loosened.

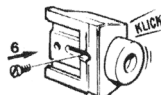
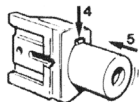
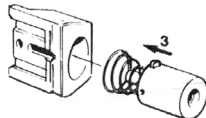
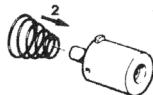
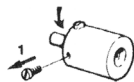

**ASSA**<sup>®</sup>  
ASSA ABLOY

ASSA OEM AB, Bruksgatan 17, 414 51 Göteborg  
Tel. +46 (0)31 - 704 40 00, info.fix@assaoem.se, www.assaoem.se

KT 864